

REOVIB WI 621 3000/6000 1/min

AC-Magnet, powder-coated

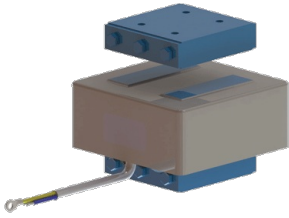

Unique Selling Point

- Corrosion protection by means of powder-coating
- FDA compliant
- Optimal size/performance ratio
- Good adjustability
- Maximum power 3900 VA
- Also for low frequency applications
- Maximum tractive power 8580 N
- Low Profile

Description

Applications:

- Packaging industry and weighing sector for feeding and sorting processes
- Automation process and assembly equipment which utilises electromagnetic drives.

Particularly suited for the food processing sector and the pharmaceutical sector (FDA compliant)

Technical Data

REOVIB WI 621 3000/6000 1/min

AC-Magnet, powder-coated

Technical data

| Types | Maximum rated air gap [mm] | Working air gap [mm] | Power at 6000 1/min [VA] | Rated current = thermal rated current at 230V [A] | Peak tensile force at nominal air gap [N] | Power at 3000 1/min [VA] | therm. rated current at 230V [A] | Peak tensile force at nominal air gap [N] | Weight [kg] | |
|----------------------------|--|----------------------|--------------------------|---|---|--------------------------|----------------------------------|---|-------------|----------|
| | | | | | | | | | Magnet | Armature |
| REOVIB WI 621/10 | 3 | 2* | 320 | 1,4 | 142 | 280 | 1,2 | 229 | 2,1 | 0,34 |
| REOVIB WI 621/12 | 3 | 2* | 391 | 1,7 | 235 | 345 | 1,5 | 318 | 2,8 | 0,62 |
| REOVIB WI 621/14 | 3 | 2* | 1200 | 5,2 | 850 | 1200 | 5,2 | 1410 | 6,9 | 1,45 |
| REOVIB WI 621/16 | 3 | 2* | 2200 | 9,5 | 1590 | 1890 | 8,2 | 2620 | 10,5 | 2,6 |
| REOVIB WI 621/17 | 3 | 2* | 3000 | 13 | 2100 | 2760 | 12 | 3600 | 18 | 3,9 |
| REOVIB WI 621/18 | 3 | 2* | -- | -- | -- | 3900 | 16,9 | 6900 | 28 | 9 |
| Compatible REOVIB-Devices: | REOVIB SMART, REOVIB RTS, REOVIB MTS, REOVIB MFS | | | | | | | | | |

REOVIB WI 621 3000/6000 1/min

AC-Magnet, powder-coated

Dimension drawing

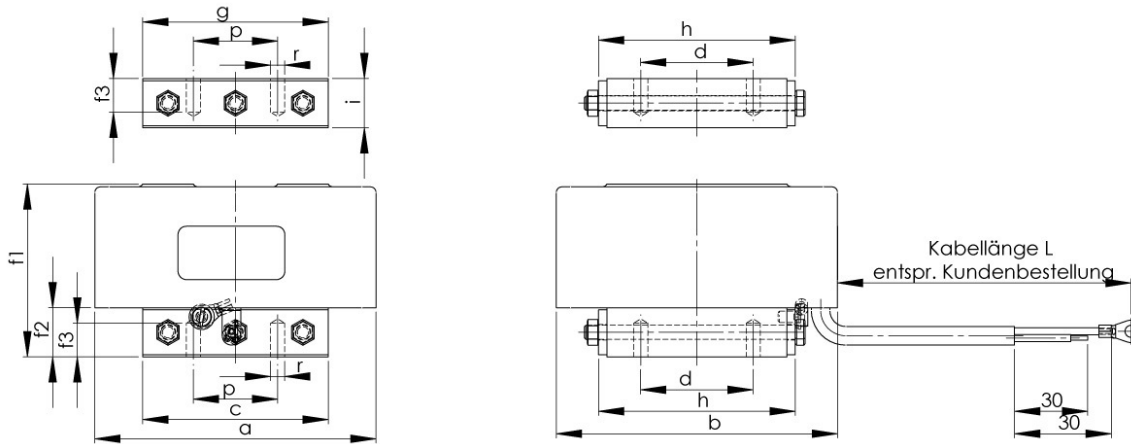

Dimensions

| Typen | a | b | c | d | f1 | f2 | f3 | g | h | i | p | r |
|------------------|-----|-----|-----|-----|-------|------|----|-----|-----|------|----|-----|
| REOVIB WI 621/10 | 100 | 68 | 67 | - | 62,5 | 12,5 | 9 | 67 | 39 | 18,5 | 30 | M6 |
| REOVIB WI 621/12 | 100 | 100 | 67 | 40 | 62,5 | 15,5 | 9 | 67 | 71 | 18,5 | 30 | M6 |
| REOVIB WI 621/14 | 155 | 110 | 109 | - | 91,5 | 23,5 | 15 | 109 | 69 | 27,5 | 50 | M10 |
| REOVIB WI 621/16 | 155 | 168 | 109 | 80 | 91,5 | 23,5 | 15 | 109 | 127 | 27,5 | 50 | M10 |
| REOVIB WI 621/17 | 165 | 230 | 109 | 110 | 91,5 | 23,5 | 15 | 109 | 181 | 27,4 | 50 | M10 |
| REOVIB WI 621/18 | 230 | 170 | 170 | 65 | 129,5 | 42,5 | 18 | 170 | 121 | 48,5 | 75 | M12 |