

# REOVIB WI 621 3000/6000 1/min

*AC-Magnet, powder-coated*

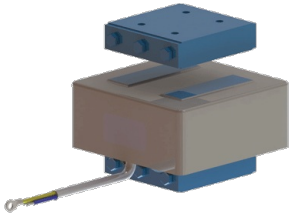

## Unique Selling Point

- Corrosion protection by means of powder-coating
- FDA compliant
- Optimal size/performance ratio
- Good adjustability
- Maximum power 3900 VA
- Also for low frequency applications
- Maximum tractive power 8580 N
- Low Profile

## Description

Applications:

- Packaging industry and weighing sector for feeding and sorting processes
- Automation process and assembly equipment which utilises electromagnetic drives.

Particularly suited for the food processing sector and the pharmaceutical sector (FDA compliant)

## Technical Data

# REOVIB WI 621 3000/6000 1/min

*AC-Magnet, powder-coated*

## Technical data

| Types                      | Maximum rated air gap [mm]                       | Working air gap [mm] | Power at 6000 1/min [VA] | Rated current = thermal rated current at 230V [A] | Peak tensile force at nominal air gap [N] | Power at 3000 1/min [VA] | therm. rated current at 230V [A] | Peak tensile force at nominal air gap [N] | Weight [kg] |          |
|----------------------------|--|----------------------|--------------------------|---|---|--------------------------|----------------------------------|---|-------------|----------|
|                            |  |                      |                          |   |   |                          |                                  |   | Magnet      | Armature |
| REOVIB WI 621/10           | 3  | 2*                   | 320                      | 1,4   | 142                                       | 280                      | 1,2                              | 229                                       | 2,1         | 0,34     |
| REOVIB WI 621/12           | 3  | 2*                   | 391                      | 1,7   | 235                                       | 345                      | 1,5                              | 318                                       | 2,8         | 0,62     |
| REOVIB WI 621/14           | 3  | 2*                   | 1200                     | 5,2   | 850                                       | 1200                     | 5,2                              | 1410                                      | 6,9         | 1,45     |
| REOVIB WI 621/16           | 3  | 2*                   | 2200                     | 9,5   | 1590                                      | 1890                     | 8,2                              | 2620                                      | 10,5        | 2,6      |
| REOVIB WI 621/17           | 3  | 2*                   | 3000                     | 13  | 2100                                      | 2760                     | 12                               | 3600                                      | 18          | 3,9      |
| REOVIB WI 621/18           | 3  | 2*                   | --                       | --  | --  | 3900                     | 16,9                             | 6900                                      | 28          | 9        |
| Compatible REOVIB-Devices: | REOVIB SMART, REOVIB RTS, REOVIB MTS, REOVIB MFS |                      |                          |   |   |                          |                                  |   |             |          |

# REOVIB WI 621 3000/6000 1/min

AC-Magnet, powder-coated

## Dimension drawing

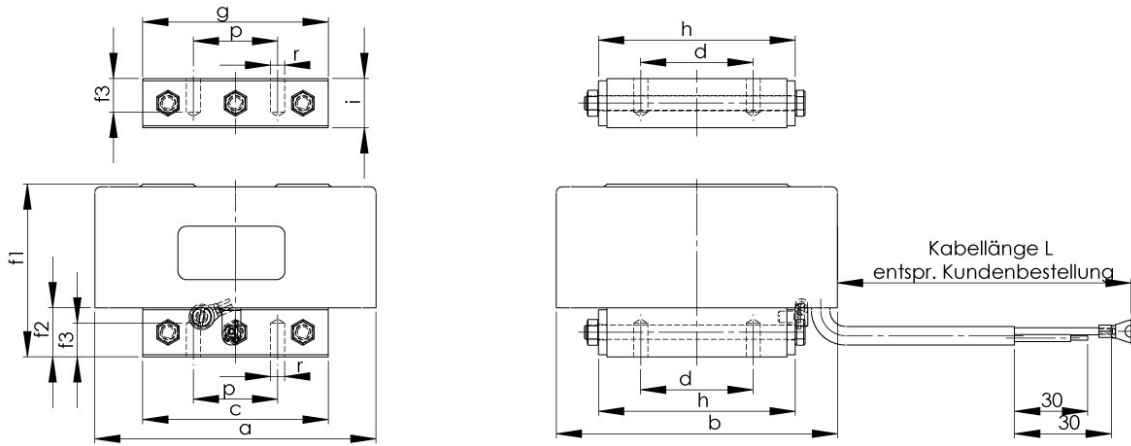

## Dimensions

| Typen            | a   | b   | c   | d   | f1    | f2   | f3 | g   | h   | i    | p  | r   |
|------------------|-----|-----|-----|-----|-------|------|----|-----|-----|------|----|-----|
| REOVIB WI 621/10 | 100 | 68  | 67  | -   | 62,5  | 12,5 | 9  | 67  | 39  | 18,5 | 30 | M6  |
| REOVIB WI 621/12 | 100 | 100 | 67  | 40  | 62,5  | 15,5 | 9  | 67  | 71  | 18,5 | 30 | M6  |
| REOVIB WI 621/14 | 155 | 110 | 109 | -   | 91,5  | 23,5 | 15 | 109 | 69  | 27,5 | 50 | M10 |
| REOVIB WI 621/16 | 155 | 168 | 109 | 80  | 91,5  | 23,5 | 15 | 109 | 127 | 27,5 | 50 | M10 |
| REOVIB WI 621/17 | 165 | 230 | 109 | 110 | 91,5  | 23,5 | 15 | 109 | 181 | 27,4 | 50 | M10 |
| REOVIB WI 621/18 | 230 | 170 | 170 | 65  | 129,5 | 42,5 | 18 | 170 | 121 | 48,5 | 75 | M12 |